

ASC550C-AP

a

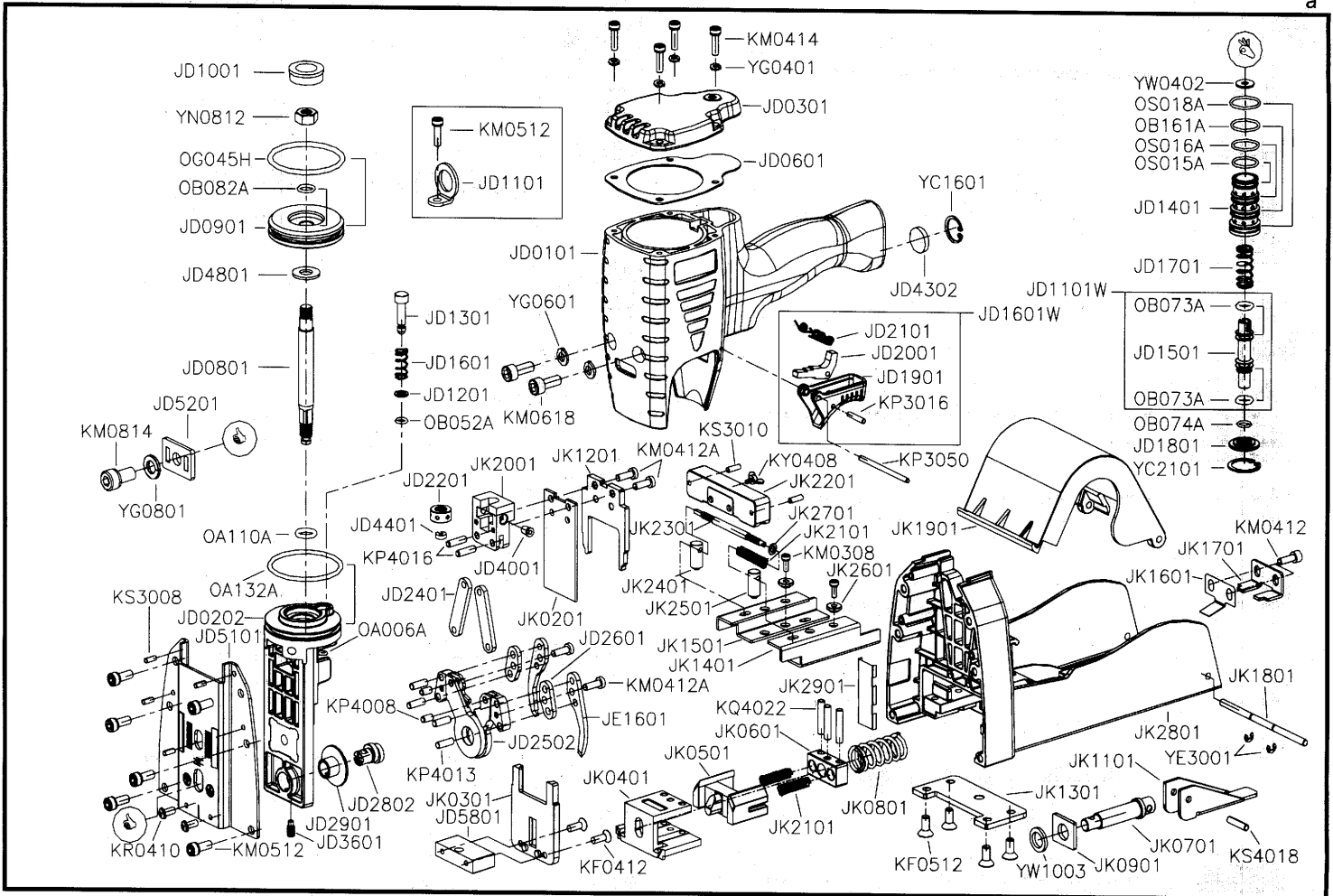

Part No	Description	Spec	Q'ty	Part No	Description	Spec	Q'ty	Part No	Description	Spec	Q'ty
JD0101	BODY		1	JK0601	BRACKET		1	KS3008	SPRING PIN	φ3-8L	4
JD0202	BODY(2)		1	JK0701	SHIRT		1	KS3010	SPRING PIN	φ3-10L	2
JD0301	CYLINDER CAP		1	JK0801	COMPRESSION SPRING		1	KS4018	SPRING PIN	φ4-18L	1
JD0601	CAP SEAL		1	JK0901	SPACER		1	KY0408	SCREW		1
JD0801	PISTON ROD		1	JK1101	HEX BAR WRENCH		1	OA006A	O-RING	ARP568-006	1
JD0901	MAIN PISTON		1	JK1201	DOWEL		1	OA110A	O-RING	ARP568-110	1
JD1001	BUMPER		1	JK1301	BOTTOM WASHER		1	OA132A	O-RING	ARP568-132	1
JD1101	HANGER		1	JK1401	GUIDE LEFT		1	OB052A	O-RING	5x1.5	1
JD1101W	TRIGGER VALVE ASSY.		1	JK1501	GUIDE RIGHT		1	OB073A	O-RING	7x2.5	2
JD1201	FLAT WASHER		1	JK1601	SPRING		1	OB074A	O-RING	7x1.5	1
JD1301	STEM		1	JK1701	FIXED SUPPORT		1	OB082A	O-RING	φ8x1.5	1
JD1401	TRIGGER VALVE SEAT		1	JK1801	SHAFT		1	OB161A	O-RING	16x1.5	1
JD1501	TRIGGER VALVE STEM		1	JK1901	CANISTER COVER		1	OG045H	O-RING	G45	1
JD1601	COMPRESSION SPRING		1	JK2001	ADJUSTABLE SEAT		1	OS015A	O-RING	S-15	1
JD1601W	TRIGGER ASSY.		1	JK2101	COMPRESSION SPRING		3	OS016A	O-RING	S-16	1
JD1701	COMPRESSION SPRING		1	JK2201	MAGAZINE COVER		1	OS018A	O-RING	S-18	1
JD1801	TRIGGER VALVE GUIDE		1	JK2301	ADJUST SHAFT		1	YC1601	C-RING	φ16	1
JD1901	TRIGGER		1	JK2401	ADJUST LUMP (R)		1	YC2101	C-RING	φ21	1
JD2001	CONTACT LEVER		1	JK2501	ADJUST LUMP (L)		1	YE3001	E-RING	φ3.0	2
JD2101	SPRING		1	JK2601	PIVOT		2	YG0401	SPRING WASHER	φ4	4
JD2201	ADJUSTING WHEEL		1	JK2701	FLAT WASHER		1	YG0601	SPRING WASHER	φ6	2
JD2401	LINK		2	JK2801	REAR BODY		1	YG0801	SPRING WASHER	φ8	1
JD2502	ANVIL HOLDER		2	JK2901	RUBBER PLATE		1	YN0812	HEX NUT	M8x1.25	1
JD2601	SPACER		2	KF0412	FLAT HD.BOLT	M4x0.7 - 12L	2	YW0402	FLAT WASHER	φ4	1
JD2802	PENETRATION ECCENTRIC		1	KF0512	FLAT HD.BOLT	M5x0.8 - 12L	4	YW1003	FLAT WASHER	φ10	1
JD2901	BUSHING		1	KM0308	HEX.SOC.HD.BOLT	M3x0.5 - 8L	2				
JD3601	RETAINER SCREW		1	KM0412	HEX.SOC.HD.BOLT	M4x0.7 - 12L	2				
JD4001	FIXED PLATE SET		1	KM0412A	HEX.SOC.HD.BOLT	M4x0.7 - 12L	4				
JD4302	MUFFLER		1	KM0414	HEX.SOC.HD.BOLT	M4x0.7 - 14L	4				
JD4401	BUSHING		1	KM0512	HEX.SOC.HD.BOLT	M5x0.8 - 12L	7				
JD4801	FLAT WASHER		1	KM0618	HEX.SOC.HD.BOLT	M6x1.0 - 18L	2				
JD5101	FRONT SECTION		1	KM0814	HEX.SOC.HD.BOLT	M8x1.25 - 14L	1				
JD5201	ADJUST SUPPORT		1	KP3016	PARALLEL PIN	φ3x16L	1				
JD5801	DISTANCE SET		1	KP3050	PARALLEL PIN	φ3x50L	1				
JE1601	ANVIL HOOK		2	KP4008	PARALLEL PIN	φ4x8L	2				
JK0201	DRIVER		1	KP4013	PARALLEL PIN	φ4x13L	4				
JK0301	COVER PLATE		1	KP4016	PARALLEL PIN	φ4x16L	2				
JK0401	ANVIL		1	KQ4022	SPRING PIN	φ4x22L	3				
JK0501	PUSHER		1	KR0410	BUTTON HD.BOLT	M4x0.7 - 10L	2				

★ If you need to order parts, please mark both Parts No. and Description. ★